

# 12-GAUGE<sup>®</sup>

## MULTI-UNIT RAPID CHARGER

### USER MANUAL



UL Listed for Safety.  
Single Plug for Convenience.



EASY-SWAP PODS.  
Available for All  
Popular Radio &  
Battery Models.

## 12-Gauge Charger Configuration

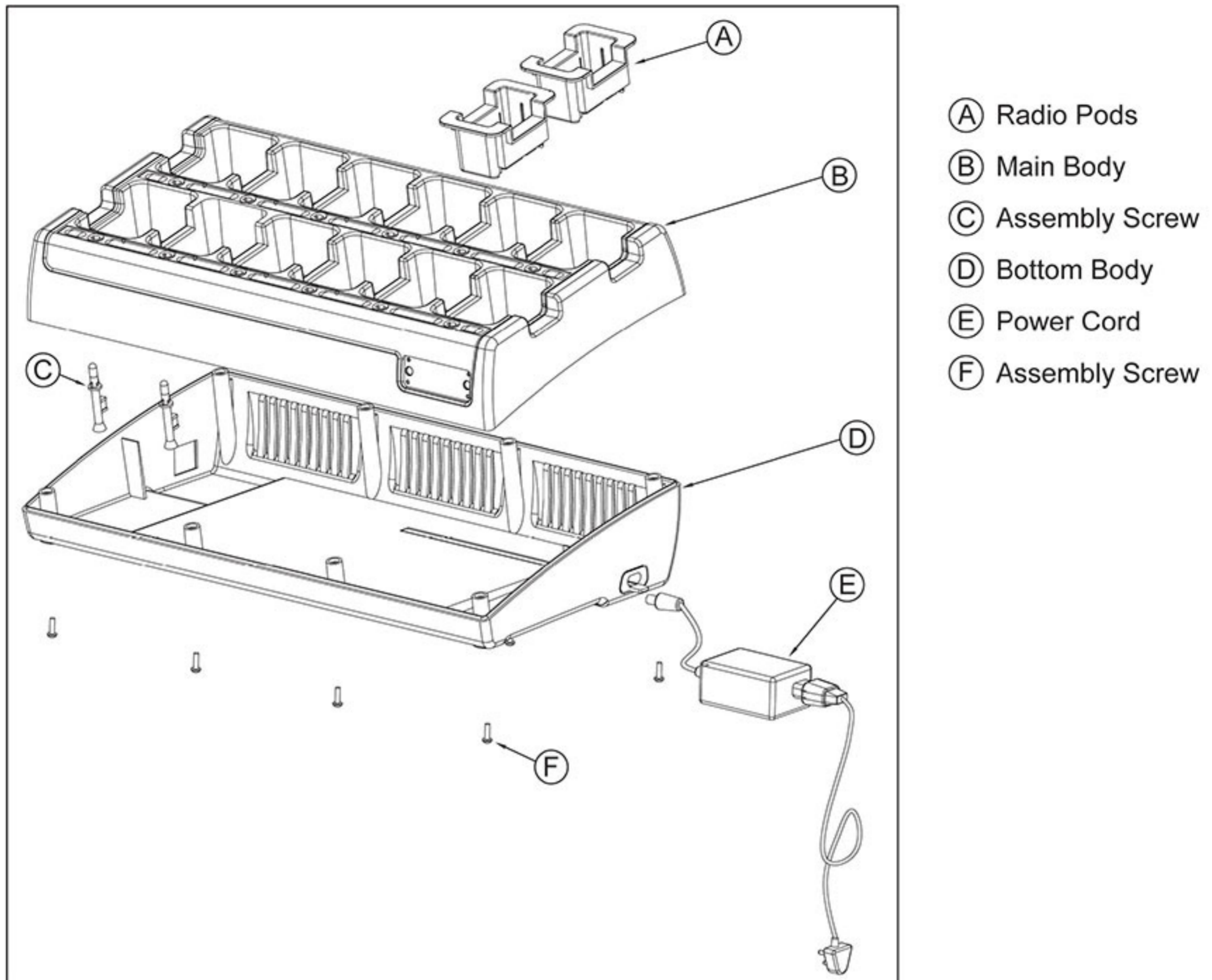

## Charging Procedure

1. Install the suitable battery adaptor in the charger unit. The battery adaptor **MUST** be locked into place using the Locking Screw, to ensure good electrical contacts (refer to fig 1).
2. Connect the AC adaptor to the charger jack on the rear of the unit.
3. Connect the AC adaptor to an AC outlet.
4. The LED indication will be orange for a few seconds during unit diagnostic, and then off when the unit is ready for operation.  
(Note that the LED will remain orange, until a battery adaptor is properly installed.)
5. Slide a battery pack or a transceiver equipped with a battery pack into the battery adaptor.
6. The LED indicator will be orange during battery diagnostic, which may last from a few seconds to a few minutes.
7. The LED indicator will be red during charging.
8. The LED indicator will be green and blinking when the charged capacity is over 80%.
9. The LED indicator will be green when the charging is completed.
10. User may remove the battery when the LED indicator is green (steady or blinking).

Notes:

1) In case of battery faults, the LED will be blinking in red color. The error codes (number of blinks) are listed below –

# Of blinks	Descriptions
1	Over current error during precharge – The battery may have a shorted circuit between “P+” and “P-“ contact.
2	Precharge time out – Precharge operation failed because the battery level remains at a low level.
3	Reserved
4	Overheat error while charging Li ion battery – Battery temperature is over 109 deg F, which is abnormal while charging a Li ion battery.
5	Battery contact is open – No charging current is passing thru the “P+” and “P-“ contact.
6	Battery is under charged – Charging is completed, but the final battery voltage is below normal level.

- 2) IMPORTANT – After a charged radio is removed, the LED indicator may remain on for a few seconds. User MUST wait for the LED to turn off, before putting another radio in the charging slot.
- 3) Using the charger outside the specified temperature range (59 – 86 deg F) may lead to erratic operation, and batteries may be under-charged.

## Unit specification

Dimension:	17” x 10” x 5.5”
Weight:	approx. 4.75 lbs.
Power Input:	110-240V 50-60Hz 2.2A max
Power Output:	15V 10A
Supported batteries:	NiCd, NiMH, Li ion, LiPo
Operating Temperature:	59 – 86 deg F
Storage Temperature:	32 – 149 deg F
Safety standard:	UL / CUL / CE / ROHS



For Support, contact Klein Electronics or your local dealer.

- [Support@KleinElectronics.com](mailto:Support@KleinElectronics.com)
- [www. KleinElectronics.com](http://www.KleinElectronics.com)